

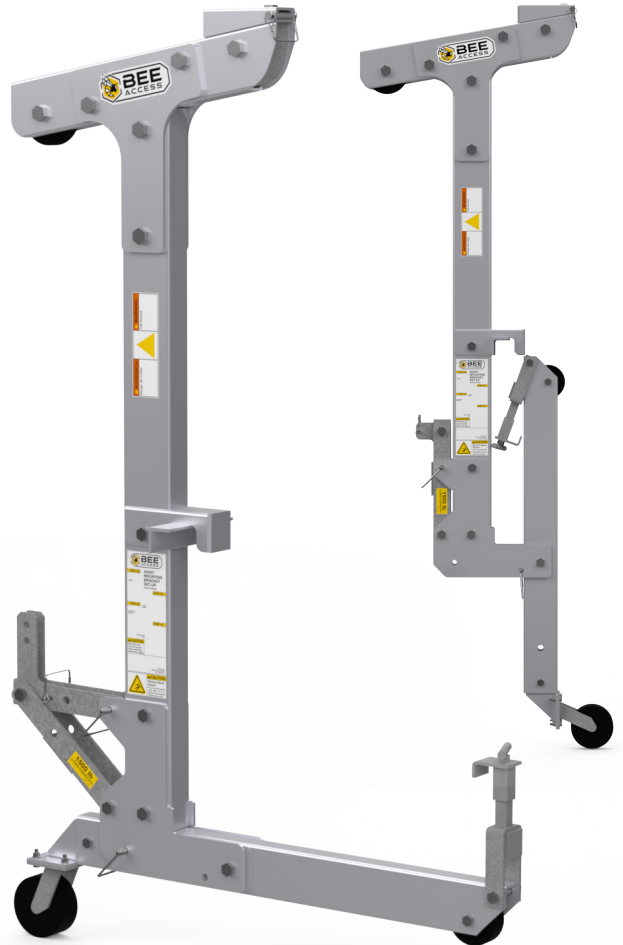

2145 Indian Road, West Palm Beach, FL 33409
Phone: 561.616.9003 www.beeaccess.com

SPEC-934150

ALUMINUM C-STIRRUP



DESCRIPTION

The Aluminum C-Stirrup is a lightweight, versatile support system for suspended platforms. Designed for maximum efficiency, this stirrup offers a 34% weight reduction compared to the steel Low Profile C-Stirrup, allowing for higher platform load capacities and enhanced productivity on the job site.

This innovative support system is not only lightweight but also extremely versatile, folding easily for quick transport and storage with just the removal of a single hitch pin. Its compact size allows it to fit through tight spaces, such as boiler hatches, ensuring access to even the most challenging work environments.

The tool-free mounting system makes positioning the stirrup with suspension points anywhere along the platform quick and easy. Interior workspace is maximized thanks to the universal hoist mounting bracket positioned outside the platform. The absence of structural welds ensures superior safety, ease of maintenance, and simplified inspections.

SPECIFICATIONS

Part No.: 934150

Load Capacity: 1,500 lb

Dimensions:

Default: 73.6" x 8.3" x 46.1" (HxWxD)

Collapsed: 86.9" x 8.3" x 29.6" (HxWxD)

Weight: 78 lb

Construction: Aluminum with steel hoist mount assembly & toeboard bracket

Compatibility: All UP-STAGE & Altrex platforms

Accessories:

934151 - Mast tube Extension

920152 - Bolt-on Secondary Wire Rope Sheave Assembly

934150-09 - Bolt-on Mid-rail Mont

1,500 lb Maximum Load Capacity

Collapses for easy handling,
transportation and storage

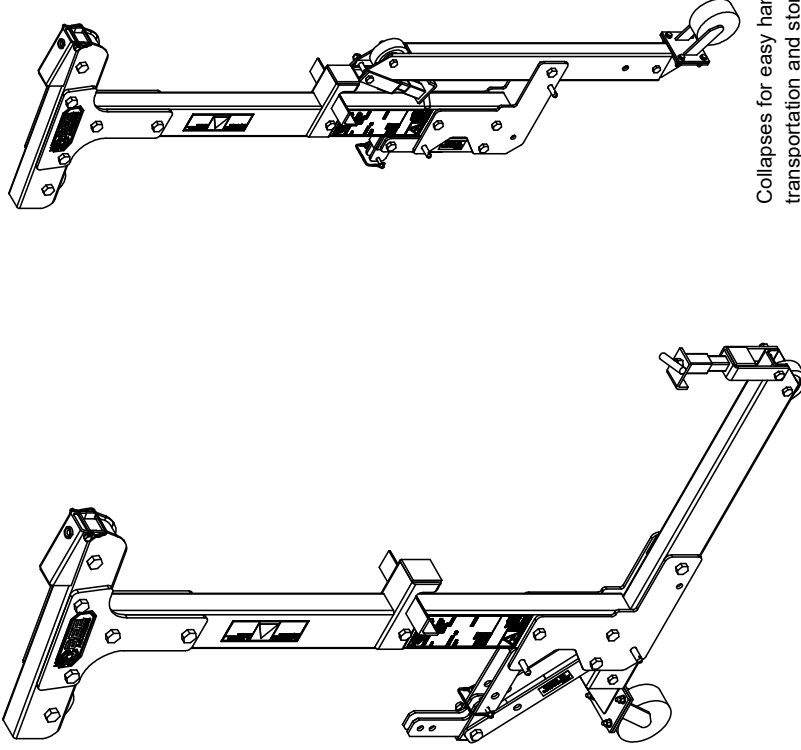
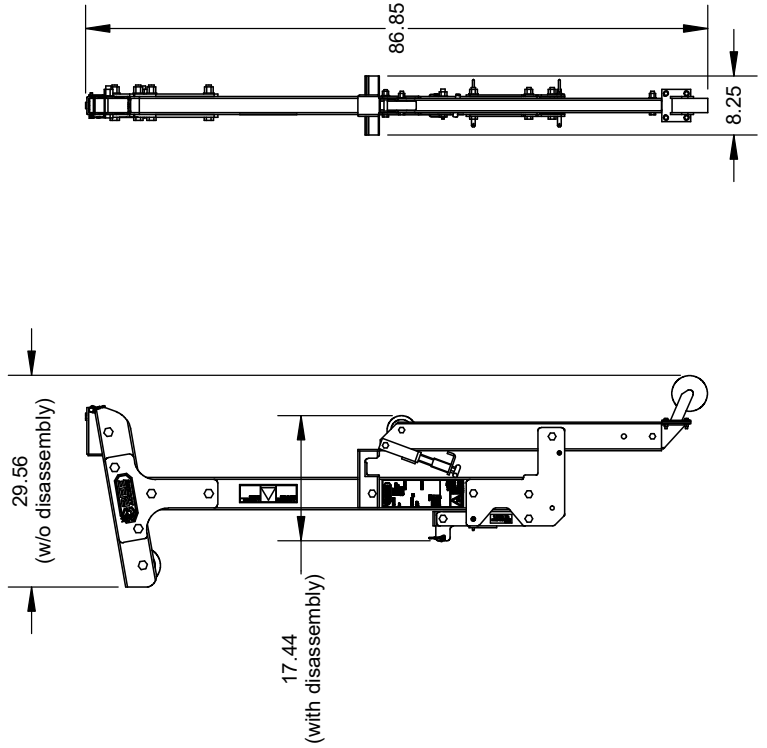
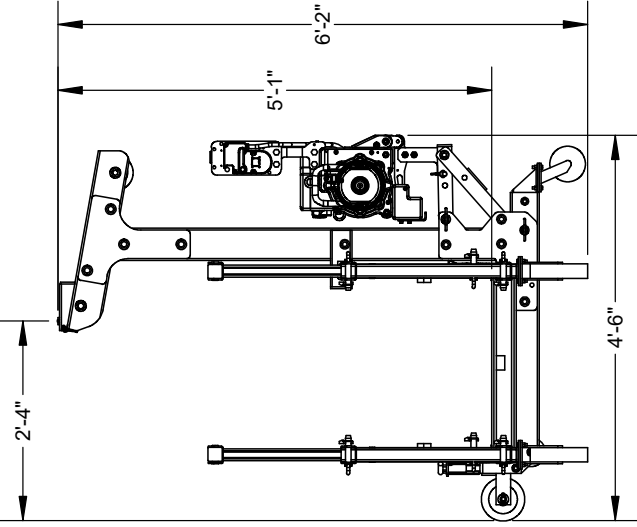

B	Extended hoist mount	RAH	07-26-24
REV	Revision Description	By	Date
	DEBUR AND BREAK SHARP EDGES		
	Material: Assembly	Weight (lb):	78
	Treatment: N/A		
	Raw matl:	Dimensions in [] are in mm	
		Tol. ISO 2768-m	
	Length (in):	> 0.5 6 30 120 400	
		< 0.5 6 30 120 400	
		TOL. ±0.1 ±0.2 ±0.3 ±0.5 ±0.8	
		Machined surfaces: 12.5	ISO 1302
		CAD generated drawing. Do not manually update. Do not scale drawing.	
	Approvals By: Date:	Decimals	Angles
	Drawn TBO 01-12-24	X ± 060	ALL ± .5°
	Approved [Signature] 07-26-24	XXX ± .015	XXX ± .005
		Fractions	
		Product Line/Project:	Platform
		REV.	B
		Part No:	934150 App
		Sheet	1 of 3



The information contained in this drawing is the sole property of Bee Access Products. Any reproduction in part or whole without the written permission of Bee Access Products is strictly prohibited.

Aluminum C-Stirrup, Application