



**MODULAR
PLATFORM**





IDENTIFICATION OF COMPONENTS



- | | | | | | |
|----|--------|-------------------------------|-----|--------|-----------------------------|
| 1. | US5DK | 0.5M Deck | 6. | USEGR | End Guard Rail |
| | US1DK | 1M Deck | 7. | USQP1 | Quick Pin, Each |
| | US15DK | 1.5M Deck | 8. | 934109 | 8 in. Caster Assy. |
| | US2DK | 2M Deck | 9. | 934102 | End Stirrup |
| | US3DK | 3M Deck | 10. | 934205 | Walk-By Stirrup, MHB60 Alu. |
| 2. | US5SF | 0.5M Side Frame | 11. | 934106 | Low Profile C-stirrup |
| | US1SF | 1M Side Frame | 12. | 934111 | Walk Thru C-stirrup |
| | US15SF | 1.5M Side Frame | 13. | 934113 | Roller Bumper, 6x15" |
| | US2SF | 2M Side Frame | 14. | 934114 | Adj. Roller Bumper |
| | US3SF | 3M Side Frame | 15. | USHS | Hinge Section |
| 3. | US5GR | 0.5M Guard Rail | 16. | USTS | T-Section |
| | US1GR | 1M Guard Rail | 17. | 423050 | Corner Section, 90° |
| | US15GR | 1.5M Guard Rail | 18. | 423055 | Corner Section, 45° |
| | US2GR | 2M Guard Rail | 19. | 423065 | Corner Section, 30° |
| | US3GR | 3M Guard Rail | 20. | 423070 | Corner Section, 15° |
| 4. | USUFR | U Frame w/8 Quick Pins | 21. | 42306A | Adj. Corner Section |
| | USUFRS | Steel U Frame w/ 8 Quick Pins | 22. | US45ES | End Section, 45° |
| 5. | USGRP | Guard Rail Post | | | |

- Available in 0.5, 1, 1.5, 2 and 3 meter sections.
- CUL classified system. Easily assembles into platform lengths up to 62 ft with load capacities up to 2,000 lbs.
- Completely knocks down for easy transport and storage.
- All aluminum modular construction makes UP-STAGE lightweight, strong and versatile.
- Components assemble fast and easy using Quickpins.
- Reversible aluminum decks extend the working life.
- Optional hinge and corner sections add versatility and allow an unlimited number of configurations.
- Many available accessories to adapt to virtually any suspended platform application.
- Unmatched factory product and application support from Bee Access.

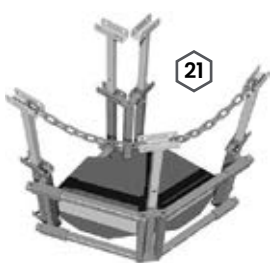
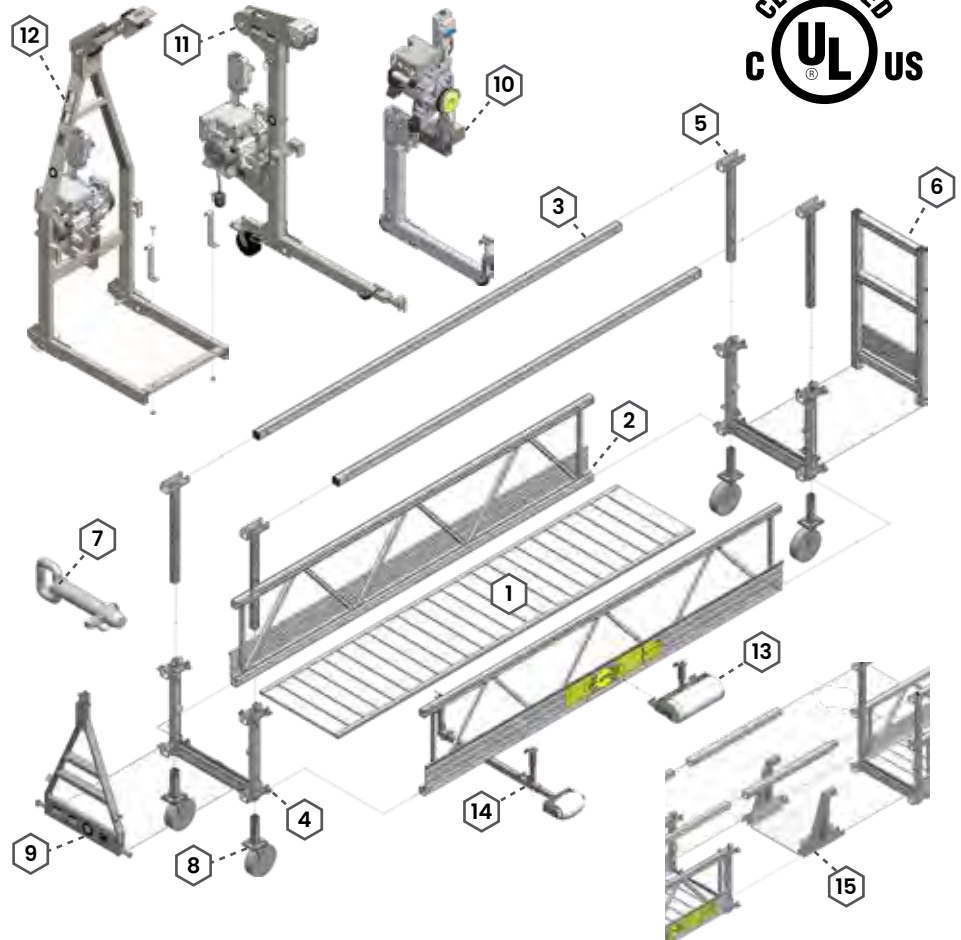



DIMENSIONS

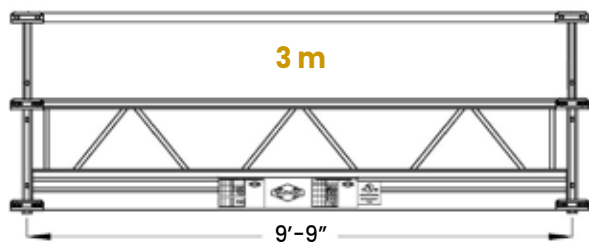
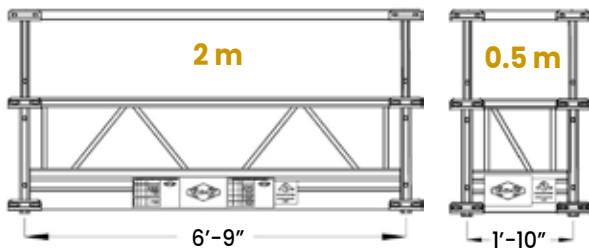
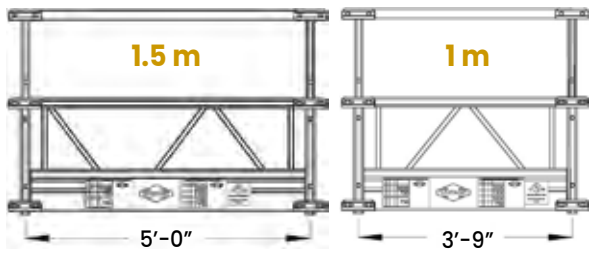

STIRRUP OPTIONS



Low Profile C-stirrup

Intermediate stirrup for flexible length cantilevers. Top of stirrup only 5 ft off the deck to get the platform closer to the rigging for better access to the top of the facade. Can be used on Work Cages up to 1 m.

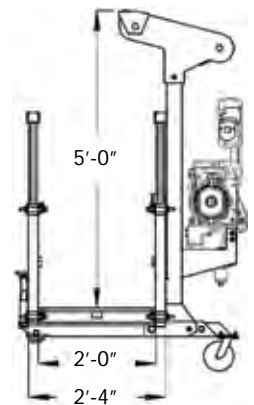

Walk-By Stirrup
Same height as End Stirrup, but with intermediate mounting for greater flexibility. No sheaves for better efficiency.



5'-9"



Walk Thru C-stirrup

The high profile design provides excellent stability, especially in workcage applications and when using porch brackets. Can be used on Work Cages up to 2 m.

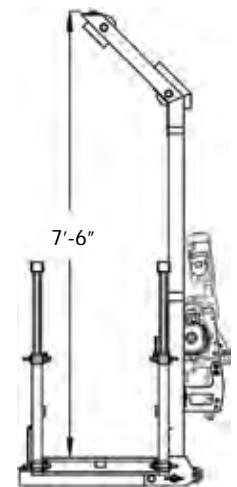



PLATFORM LENGTHS – CONFIGURATIONS SELF WEIGHT – LOAD CAPACITIES

TOTAL LENGTH		CANTILEVER LENGTH		HOIST DISTANCE		PLATFORM CONFIGURATION (M)	TOTAL PLATFORM WEIGHT*		MAXIMUM RATED WORKING LOAD	
FT	M	FT	M	FT	M	= END STIRRUP	LB	KG	LB	KG
6' - 9"	2	NONE		6' - 9"	2	2	176	80		
9' - 9"	3	NONE		9' - 9"	3	3	233	106		
13' - 6"	4	NONE		13' - 6"	4	2-2	289	131	2000	900
16' - 6"	5	NONE		16' - 6"	5	3-2	344	156		
19' - 6"	6	NONE		19' - 6"	6	3-3	367	167		
23' - 3"	7	NONE		23' - 3"	7	2-3-2	455	206	1500	680
26' - 3"	8	NONE		26' - 3"	8	3-2-3	491	223		
29' - 3"	9	NONE		29' - 3"	9	3-3-3	541	245		
33' - 0"	10	NONE		33' - 0"	10	3-2-2-3	609	276	1000	450
36' - 0"	11	NONE		36' - 0"	11	3-3-3-2	653	296		
39' - 0"	12	NONE		39' - 0"	12	3-3-3-3	696	316		
42' - 9"	13	NONE		42' - 9"	13	3-3-2-2-3	774	351	750	340
45' - 9"	14	NONE		45' - 9"	14	3-3-2-3-3	807	366		
48' - 9"	15	NONE		48' - 9"	15	3-3-3-3-3	850	386		
FT	M	FT	M	FT	M	= "C" - STIRRUP	LB	KG	LB	KG
33' - 9"	10	3' - 9"	1	26' - 3"	8	3-2-3	871	395		
36' - 9"	11	3' - 9"	1	29' - 3"	9	3-3-3	913	414		
40' - 6"	12	3' - 9"	1	33' - 0"	10	3-2-2-3	981	445	1000	450
43' - 6"	13	3' - 9"	1	36' - 0"	11	3-3-3-2	1023	464		
46' - 6"	14	3' - 9"	1	39' - 0"	12	3-3-3-3	1067	484		
50' - 3"	15	3' - 9"	1	42' - 9"	13	3-3-2-2-3	1135	515		
53' - 3"	16	3' - 9"	1	45' - 9"	14	3-3-2-3-3	1177	534	750	340
56' - 3"	17	3' - 9"	1	48' - 9"	15	3-3-3-3-3	1222	554		
46' - 6"	14	6' - 9"	2	33' - 0"	10	2 3-2-2-3 2	1069	485		
49' - 6"	15	6' - 9"	2	36' - 0"	11	2 3-3-3-2 2	1111	504		
52' - 6"	16	6' - 9"	2	39' - 0"	12	2 3-3-3-3 2	1155	524	750	340
56' - 3"	17	6' - 9"	2	42' - 9"	13	2 3-3-2-2-3 2	1224	555		
59' - 3"	18	6' - 9"	2	45' - 9"	14	2 3-3-2-3-3 2	1266	574		
62' - 3"	19	6' - 9"	2	48' - 9"	15	2 3-3-3-3-3 2	1310	594		

EXPLANATION OF CANTILEVERED SECTIONS

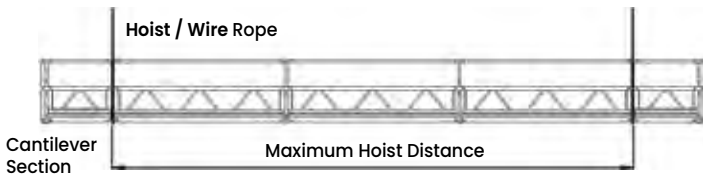

EXAMPLE OF CHART PLATFORM CONFIGURATION

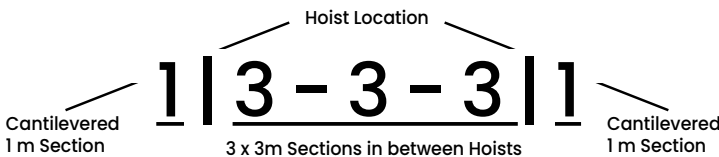

TOTAL PLATFORM WEIGHT INCLUDES:

Stirrups, but not the hoist, roller bumpers, casters, material or workers.

NOTES:

- All platform configurations as shown in the chart were tested and classified by U.L.
- Any platform configuration not listed on this chart must be approved by Bee Access or a competent and trained person from an authorized dealer.
- Chart above takes into consideration that two (2) hoists are used.
- Rated Working Load must be evenly distributed on Platform.



2145 Indian Road, West Palm Beach, FL 33409
Phone: 561.616.9003 www.beeaccess.com

