

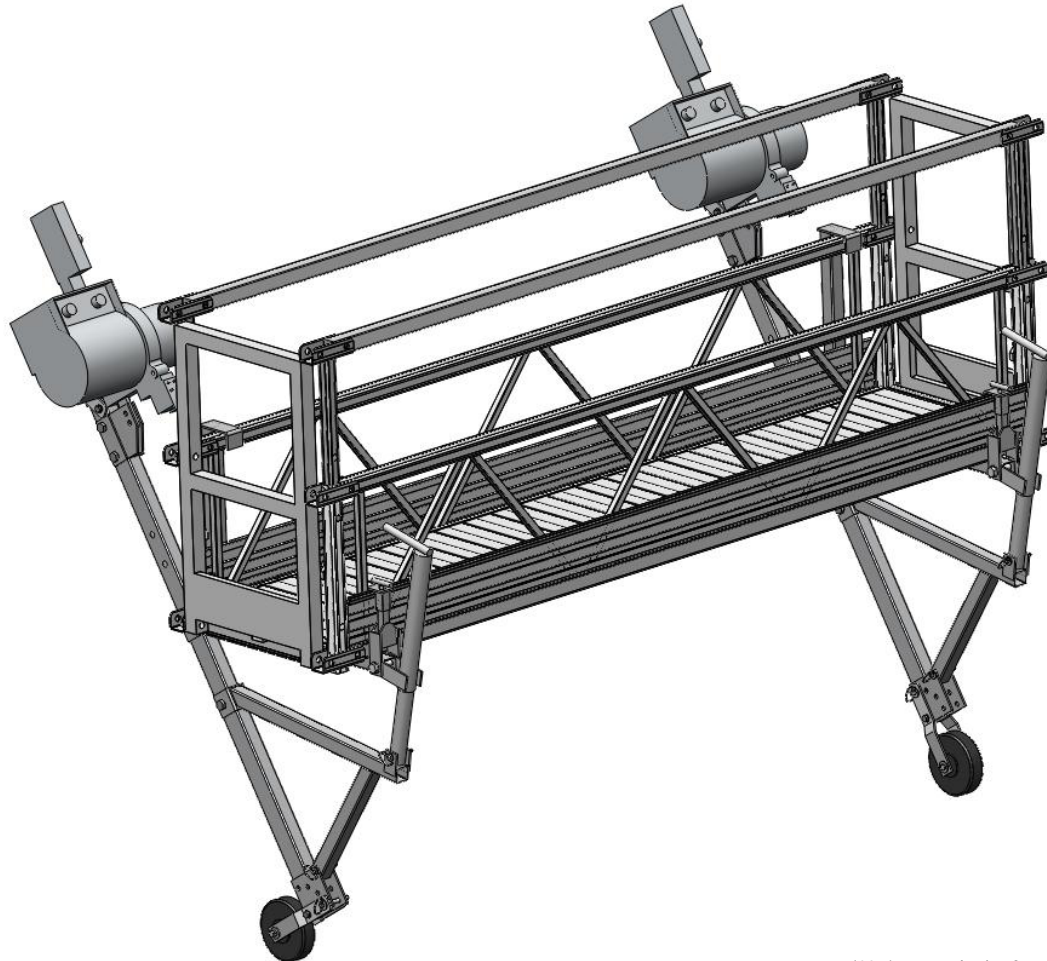

*Headquarters:* 2145 Indian Road | West Palm Beach, Florida 33409 | Phone (888) or (561) 616-9003 | Fax (561) 616-9005  
*West Coast Branch:* 11947 E. Florence Ave, Ste 5 | Santa Fe Springs, CA 90670 | Phone (562) 903-0004 | Fax (562) 903-0006

## Incline Stirrup

### Assembly & Operating Instruction Manual



\*Hoists and platform not included

#### Description

The incline stirrup is ideal for dams, pyramid shaped buildings and other structures that are under an incline. The adjustments are infinite from 45-85 degrees or 7-47 degrees with supplied adapter bracket.

**Versatile!** Can be mounted anywhere along a Side Frame. The mounting bracket fits all popular traction hoists. Various wheel configurations are available.

**Strong!** Steel construction.

#### Specifications

**Part No.:** 934139

**Load Capacity:** 1,000 lbs.

**Dimensions:** 82 x 9 x 7 in. (H x D x W)

**Weight:** 94 lbs. (each side)

**Construction:** Steel

**Finish:** Grey Powder Coat or Galvanized



*Headquarters:* 2145 Indian Road | West Palm Beach, Florida 33409 | Phone (888) or (561) 616-9003 | Fax (561) 616-9005  
*West Coast Branch:* 11947 E. Florence Ave, Ste 5 | Santa Fe Springs, CA 90670 | Phone (562) 903-0004 | Fax (562) 903-0006

## **GENERAL WARNING - Read First**

**Safety is a matter of life or death for riggers, operators and by-standers.  
This warning is your share of duties for achieving safety.**

### Your duty to understand and comply:

1. It is imperative for safety and efficiency of operations that this manual be read and fully understood by the rigger and the operator before rigging and using this equipment. All instructions contained herein must be carefully and strictly followed, including applicable Bee Access guidelines.
2. Should you hand over this equipment under any conditions, to any party operating out of your control, you must attach a clean copy of this manual and draw to other party's attention that strictly following all the instructions therein is a matter of life or death.
3. Before using this equipment, the rigger and the operator must become aware of all requirements of federal, state, provincial and local safety regulations, applicable to the entire suspended scaffold system and any component of it.
4. Never load this equipment above its rated load of **1000 lbs.**
5. Bee Access declines any responsibility for any special layouts, rigging or structural combinations beyond the descriptions of this manual.
6. Bee Access declines any responsibility for any other use of this equipment, than described in this manual.

### Your duty to inspect and maintain:

7. Keep this manual available at all times for easy reference whenever required. Extra copies are available from Bee Access and/or your equipment supplier.
8. Carefully take notice of all labels affixed to the equipment. Never rig or operate this equipment if any label, normally fixed on it is obscured or missing. Replacement labels are available from Bee Access and/or your equipment supplier.
9. Every time the suspended scaffold is to be rigged or used, check that the Tieback Anchor, rigging, hoists, platform and other components are complete and in good working condition, prior to proceeding. All wire ropes and safety lines and their protective sleeves should be inspected at the beginning of every shift. Check for wear and abrasion due to contact with rigging equipment and/or the building structure.
10. **Inspection is to be carried out by personnel authorized by Bee Access once every six months.** Thoroughly check overall condition for bent, damaged or worn parts and broken welds. A signed and dated inspection record should be maintained for these purposes.
11. Make sure to comply with inspection and maintenance guidelines of all other components used in the suspended scaffold system.
12. Bee Access declines any responsibility for consequences of repairs or modifications brought out of its control to the product, specifically by replacement of original parts or repairs by another manufacturer.

### Your duty to train and control people:

- Compliance with safety rules extends to rigging operations which must be carried out only after securing safe conditions of operation as per safety regulations and requirements.
13. An operator must not be assigned to rigging, de-rigging, moving or operating a suspended scaffold if that person is not:
    - a. Mentally and physically fit for the purpose, especially at heights
    - b. Competent for the job to be performed
    - c. Familiar with the scaffold equipment as rigged
    - d. Professionally trained for working under the above requirements
  14. Never let the equipment be moved or operated by unauthorized personnel. Keep the equipment, either rigged or unrigged, out of reach of unauthorized persons, while out of operation.
  15. Every suspended job must be placed under the control of a person having the required competence and authority for checking that all the instructions prescribed by this manual be regularly and efficiently carried out.

### Your duty to safety of the entire scaffold system:

- A suspended scaffold system is made up of numerous pieces of equipment; all of these components can contribute to the required safety only if:
16. Other components meet the requirements of the applicable safety regulations and requirements, are of the proper quality, assembled to form a safe and efficient suspended system and compatibility is approved by Bee Access.
  17. The supporting structure and tie-backs can withstand every load to be applied, either static or dynamic, during rigging or operating of the suspended scaffold equipment.
  18. All the requirements in strength and resistance are obtained with the necessary safety coefficients (call your supplier for regulations and professional standards).
  19. All the calculations, design and subsequent work necessary to meet the above requirements have been made by a competent person on the basis of proper technical information regarding the site.

**NOTE:** This manual is neither a regulations compliance manual nor a general training guide on suspended scaffold operations. You must refer to proper instructions delivered by your supplier of the other pieces of equipment included in your suspended scaffold installation. Whenever calculations and specific rigging and handling are involved, the operator should be professionally trained to that end and secure relevant information prior to commencing such work.

**Read and comply with the "Code of Safe Practices for Suspended Powered Scaffolds" issued by the Scaffold Industry Association (also available from Bee Access or your supplier).**



Headquarters: 2145 Indian Road | West Palm Beach, Florida 33409 | Phone (888) or (561) 616-9003 | Fax (561) 616-9005  
West Coast Branch: 11947 E. Florence Ave, Ste 5 | Santa Fe Springs, CA 90670 | Phone (562) 903-0004 | Fax (562) 903-0006

## Incline Stirrup

### Assembly Instructions

**Tools Required:**

- (1) 3/4" Socket
- (1) 1-1/8" Socket
- (1) Adjustable Wrench

**NOTE:**

Assembly must be performed or supervised by a competent and trained person. Read and fully understand these instructions before proceeding with assembly. Make sure warning/rating labels are in place, legible and have been read.

**Assembly Instructions:**

1. Bolt upper Tire Assembly (Item #3) to top side of the Side Support Weldment (Item #2).
2. Bolt Hoist Stirrup Weldment (Item #7) to the desired location on the Side Support Weldment (Item #2).
3. Bolt Stage Support Weldment (Item #1) to the Side Support Weldment.
4. If inclined surface is 7 - 47 degrees, bolt Jack Support Weldment (Item #5) to the Side Support Weldment and pin at the lower position.
5. If inclined surface is 45 - 85 degrees, pin the Jack (Item #4) to the Side Support Weldment (Item #2) and skip step #6
6. Pin the Jack (Item #4) to the Jack Support Weldment (Item #5).
7. Bolt lower Tire Assembly (Item #3) to the bottom side of the Side Support Weldment (Item #2).
8. Rotate Tire Assembly (Item #3) to desired location and pin into position.
9. Assemble platform where each incline stirrup is located near each end and adjust the Holder Weldment (Item #19) until it is snug on the toeboard.

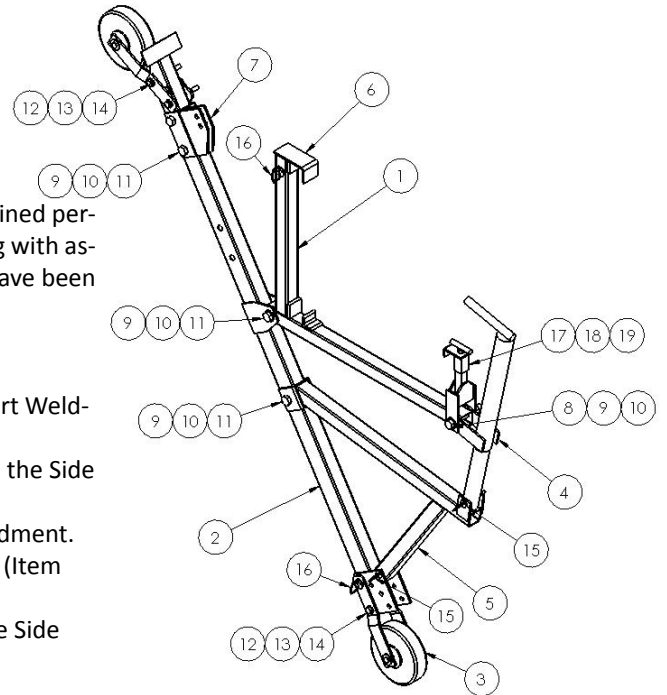

**! WARNING:**

- Any assembly of this equipment other than in strict accordance with these instructions shall be at the Operator's risk and may result in death or serious injury.

### Parts List - 934139

Item	Qty.	Part No.	Description
1	2	530285	Angled Stage Support Wldmnt
2	2	530286	Angled Side Support Wldmnt
3	4	530287	Angled Tire Assembly
4	2	530293	Jack Assembly
5	2	530290	Angled Large Jack Support Wldmnt
6	2	530291	Angled Stage Clamp-in Wldmnt
7	2	530292	Angled Hoist Stirrup Wldmnt
8	2	110285	Bolt, 3/4"x5"
9	14	110480	Washer, Flat 3/4 SAE
10	10	110382	Nut, Lock 3/4"

Item	Qty.	Part No.	Description
11	8	110284	Bolt, 3/4"x4"
12	6	110257	Bolt, 1/2"x5
13	12	110451	Washer, 1/2 Flat
14	6	110352	Nut, Lock 1/2"
15	8	110112	3/8 Hitch Pin (3in Lg) w/ Cotter Pin
16	4	110113	1/2 Hitch Pin (3.5in Lg) w/ Cotter Pin
17	2	530315	Angled Stirrup, Strap Wldmnt
18	2	530270	Low Profile, T-handle Wldmnt
19	2	530273	Low Profile, Holder Wldmnt

Spare parts used for all equipment must be in accordance with the product, no substitutions are allowed.



Headquarters: 2145 Indian Road | West Palm Beach, Florida 33409 | Phone (888) or (561) 616-9003 | Fax (561) 616-9005  
West Coast Branch: 11947 E. Florence Ave, Ste 5 | Santa Fe Springs, CA 90670 | Phone (562) 903-0004 | Fax (562) 903-0006

## Incline Stirrup

### Operating Instructions

#### Operating Instructions:

1. Verify that the distance between rigging points is correct (distance between suspension points is equal to the distance between hoists.)
2. Level the platform by turning the handle on the Jack (NOTE: Turn both jacks at the same time). If the platform does not become level, see illustration #1 and #2 to determine if the jack support weldment is required.
3. Before each work shift, verify that all connections are secure and that each tieback rope is properly attached to an anchor (nothing has been disconnected or come loose.)

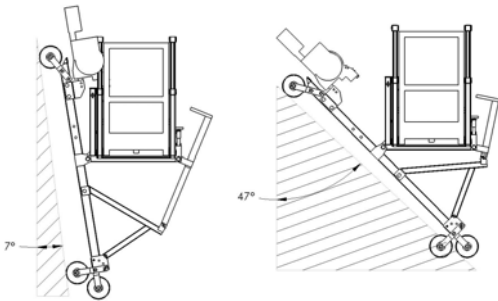
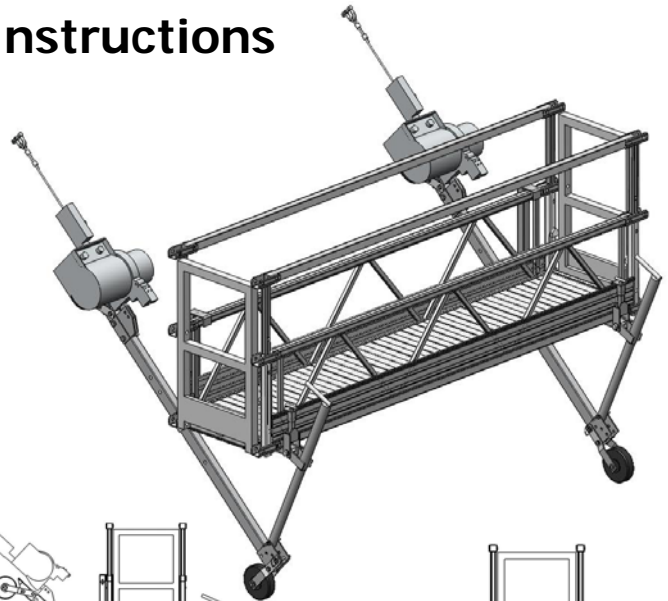

*Illustration #1: Demonstrates the Incline Stirrup with the jack support weldment, allowing level access to 7 - 47 degree surfaces.*

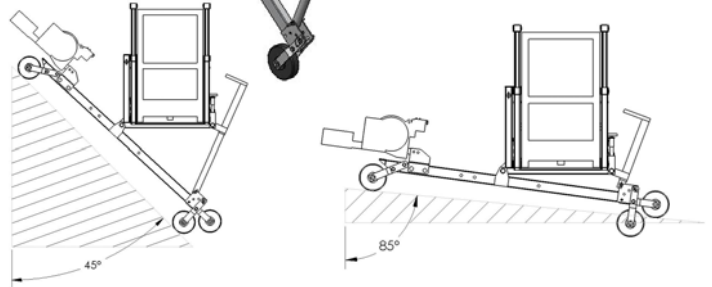

*Illustration #2: Demonstrates the Incline Stirrup without the jack support weldment, allowing level access to 45 - 85 degree surfaces.*

#### NOTE:

- All pictures and drawings in this manual are for illustrative purposes only.
- This manual is intended for general information only. Because of the many variables which affect the performance of this equipment, some of the information in this manual may not apply. For specific applications, contact Bee Access.
- Erection, use, maintenance, and disassembly must conform to current Bee Access instructions as well as ALL federal, state, provincial, and local regulations.

**⚠ WARNING:** Any use of this equipment other than in strict accordance with these instructions shall be at the Operator's risk and may result in death or serious injury.

#### **⚠** Operating Warnings:

- It is the user's responsibility to read and understand the warnings listed in this manual and to operate the Incline Stirrup with these warnings in mind.
- Use only Bee Access provided hardware. Do not substitute.
- Maximum capacity: 1,000 lbs.
- It is the users responsibility to ensure that the structure (where each Incline Stirrup is located) is capable of holding 4,000 lbs.

### Labels

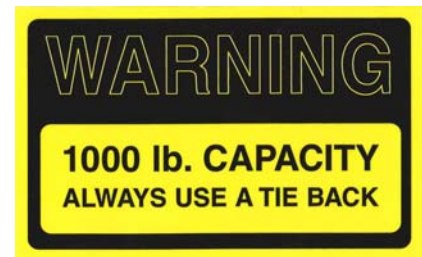

Part Number: 822101