



MODULAR PLATFORM

Relax. It's an Altrex.





Relax. It's an Altrex.

Since 1985, the Altrex MHB system has been the modular platform leader in the U.S. and around the world. Choosing Altrex is choosing safety, quality, performance and durability. The advantages of the Altrex Modular Platform System are:

Safety: Smart design does not rely on any welds for structural integrity. Altrex is certified by UL and meets or exceeds all current OSHA and ANSI industry standards.

Quality: Components are made from special aluminum extrusions. The ISO certified manufacturing process, in combination with the use of welding robots and double quality control, results in the highest level of consistent quality in the industry.

Performance: Modular design makes transportation easy. Components fit together with exact tolerances and are assembled fast and easy using Quickpins. Long lengths ensure good productivity. A multitude of accessories allow for flexibility and many possible applications.

- Available in 0.5, 1, 2 and 3m sections.
- Easily assembles into platform lengths up to 62ft with load capacities up to 2,000 lbs.
- Completely knocks down for easy transport and storage.
- All aluminum modular construction makes ALTREX lightweight, strong and versatile.
- Components assemble fast and easy using Quickpins.
- Reversible aluminum decks extend the working life.
- Optional hinge and corner sections add versatility and allow an unlimited number of configurations.
- Double Wide and Boiler Stage available for special applications.
- Many accessories available to adapt to virtually any suspended platform application, with unmatched factory product and application support from Bee Access.

Identification Of Components

- 422905 0.5M Deck
- 422910 1M Deck
- 422920 2M Deck
- 422930 3M Deck
- 421005 0.5M Side Frame
- 421061 1M Side Frame
- 421062 2M Side Frame
- 421063 3M Side Frame
- 422055 0.5M Guard Rail
- 422011 1M Guard Rail
- 422012 2M Guard Rail
- 422013 3M Guard Rail
- 421508 U Frame w/ 8 Quickpins
- 421520 Guard Rail Post
- 423072 End Guard Rail
- 424001 Quick Pin, Each
- 934109 8 in. Caster Assembly
- 934102 End Stirrup
- 934205 Walk-By Stirrup, MHB60 Alu.
- 934106 Low Profile C-stirrup
- 934111 Walk Thru C-stirrup
- 934113 Roller Bumper, 6x15"
- 934114 Adj. Roller Bumper
- USHS Hinge Section
- USTS T-Section
- 423050 Corner Section, 90°
- 423055 Corner Section, 45°
- 423065 Corner Section, 30°
- 423070 Corner Section, 15°
- 42306A Adj. Corner Section
- US45ES End Section, 45°

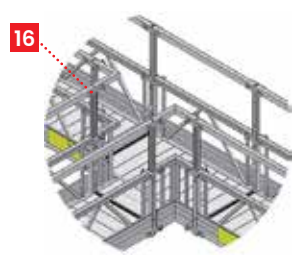
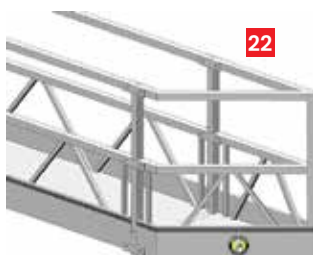
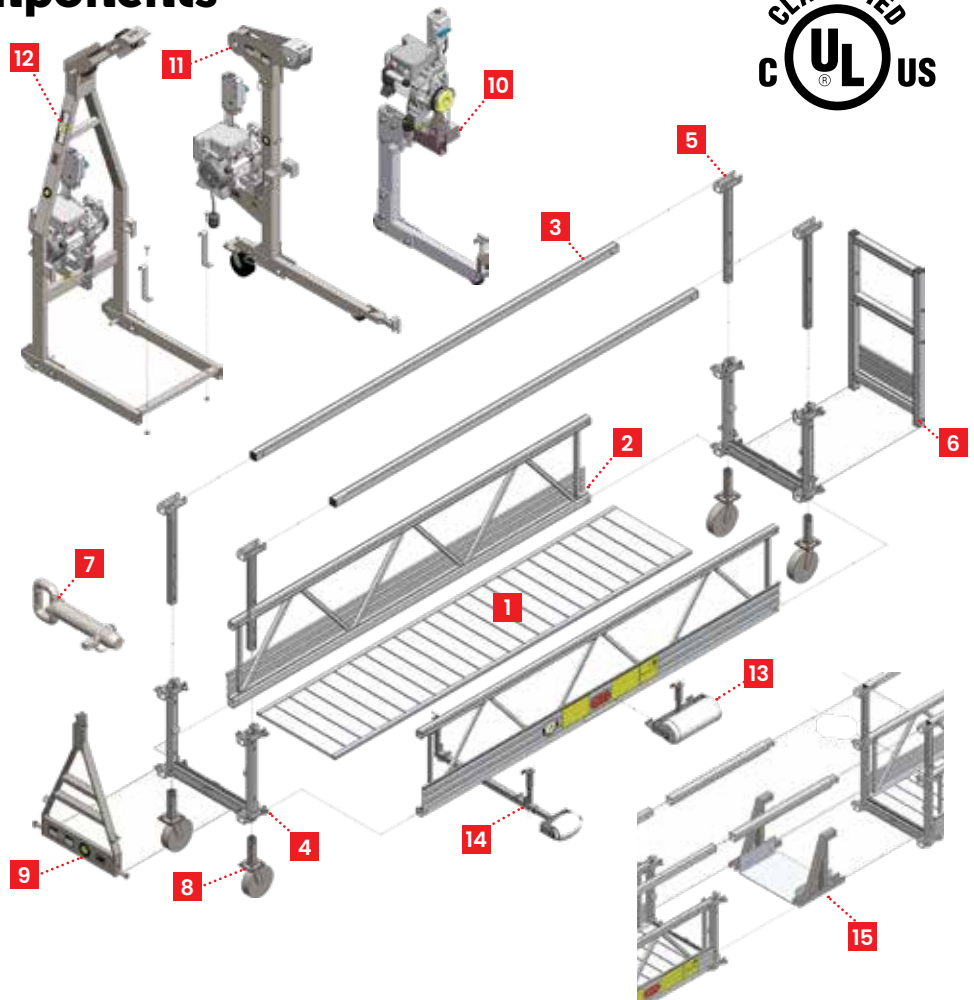



Dimensions

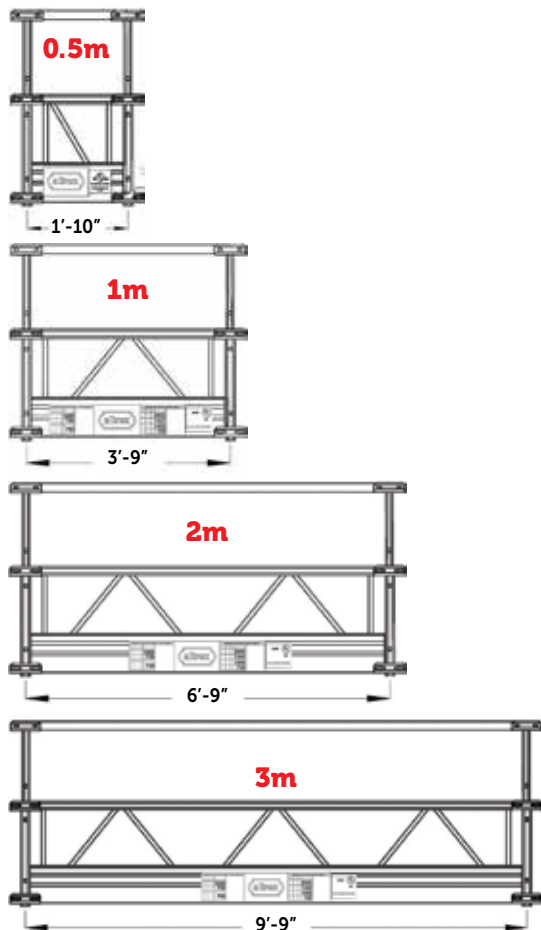

Stirrup Options



Low Profile C-stirrup

Intermediate stirrup for flexible length cantilevers. Top of stirrup only 5ft off the deck to get the platform closer to the rigging for better access to the top of the facade. Can be used on Work Cages up to 1m.

Walk-By Stirrup

Same height as End Stirrup, but with intermediate mounting for greater flexibility. No sheaves for better efficiency.



Walk Thru C-stirrup

The high profile design provides excellent stability, especially in workcage applications and when using porch brackets. Can be used on Work Cages up to 2m.

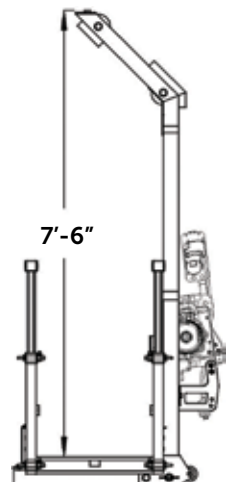
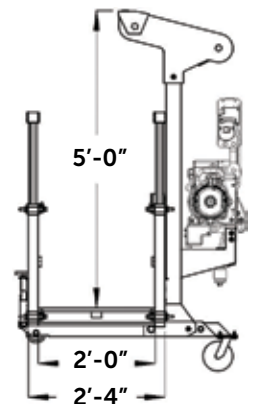

altrex



Platform Lengths - Configurations Self Weight - Load Capacities

| TOTAL LENGTH | | CANTILEVER LENGTH | | HOIST DISTANCE | | PLATFORM CONFIGURATION (M) = END STIRRUP | TOTAL PLATFORM WEIGHT | | MAXIMUM RATED WORKING LOAD | |
|--------------|----|-------------------|---|----------------|----|---|-----------------------|-----|----------------------------|-----|
| FT | M | FT | M | FT | M | | LB | KG | LB | KG |
| 6' - 9" | 2 | NONE | | 6' - 9" | 2 | 2 | 257 | 117 | | |
| 9' - 9" | 3 | NONE | | 9' - 9" | 3 | 3 | 306 | 139 | | |
| 13' - 6" | 4 | NONE | | 13' - 6" | 4 | 2-2 | 358 | 163 | 2000 | 900 |
| 16' - 6" | 5 | NONE | | 16' - 6" | 5 | 3-2 | 407 | 185 | | |
| 19' - 6" | 6 | NONE | | 19' - 6" | 6 | 3-3 | 456 | 207 | | |
| 23' - 3" | 7 | NONE | | 23' - 3" | 7 | 2-3-2 | 508 | 231 | 1500 | 680 |
| 26' - 3" | 8 | NONE | | 26' - 3" | 8 | 3-2-3 | 557 | 253 | | |
| 29' - 3" | 9 | NONE | | 29' - 3" | 9 | 3-3-3 | 606 | 275 | | |
| 33' - 0" | 10 | NONE | | 33' - 0" | 10 | 3-2-2-3 | 658 | 299 | 1000 | 450 |
| 36' - 0" | 11 | NONE | | 36' - 0" | 11 | 3-3-2-3 | 707 | 321 | | |
| 39' - 0" | 12 | NONE | | 39' - 0" | 12 | 3-3-3-3 | 756 | 343 | | |
| 42' - 9" | 13 | NONE | | 42' - 9" | 13 | 3-3-2-2-3 | 808 | 367 | 750 | 340 |
| 45' - 9" | 14 | NONE | | 45' - 9" | 14 | 3-3-2-3-3 | 857 | 389 | | |
| 48' - 9" | 15 | NONE | | 48' - 9" | 15 | 3-3-3-3-3 | 906 | 411 | | |
| FT | M | FT | M | FT | M | USING "C" - STIRRUP | LB | KG | LB | KG |
| 23' - 3" | 7 | 3' - 9" | 1 | 16' - 6" | 5 | 2-3-2 | 662 | 301 | | |
| 26' - 3" | 8 | 3' - 9" | 1 | 19' - 6" | 6 | 3-2-3 | 711 | 323 | | |
| 30' - 9" | 9 | 3' - 9" | 1 | 23' - 3" | 7 | 3-3-3 | 760 | 345 | | |
| 33' - 9" | 10 | 3' - 9" | 1 | 26' - 3" | 8 | 3-2-2-3 | 812 | 369 | 1000 | 450 |
| 36' - 9" | 11 | 3' - 9" | 1 | 29' - 3" | 9 | 3-2-3-3 | 861 | 391 | | |
| 40' - 6" | 12 | 3' - 9" | 1 | 33' - 0" | 10 | 3-3-3-3 | 910 | 413 | | |
| 43' - 6" | 13 | 3' - 9" | 1 | 36' - 0" | 11 | 3-3-2-2-3 | 962 | 437 | | |
| 46' - 6" | 14 | 3' - 9" | 1 | 39' - 0" | 12 | 3-3-2-3-3 | 1011 | 459 | | |
| 50' - 3" | 15 | 3' - 9" | 1 | 42' - 9" | 13 | 3-3-3-3-3 | 1060 | 481 | 750 | 340 |
| 53' - 3" | 16 | 3' - 9" | 1 | 45' - 9" | 14 | 3-3-2-2-3-3 | 1112 | 505 | | |
| 56' - 3" | 17 | 3' - 9" | 1 | 48' - 9" | 15 | 3-3-3-2-3-3 | 1161 | 527 | | |
| 46' - 6" | 14 | 6' - 9" | 2 | 33' - 0" | 10 | 3-3-2-3-3 | 1011 | 459 | | |
| 49' - 6" | 15 | 6' - 9" | 2 | 36' - 0" | 11 | 3-3-3-3-3 | 1060 | 481 | | |
| 52' - 6" | 16 | 6' - 9" | 2 | 39' - 0" | 12 | 3-3-2-2-3-3 | 1112 | 505 | 750 | 340 |
| 56' - 3" | 17 | 6' - 9" | 2 | 42' - 9" | 13 | 3-3-3-2-3-3 | 1161 | 527 | | |
| 59' - 3" | 18 | 6' - 9" | 2 | 45' - 9" | 14 | 3-3-3-3-3-3 | 1210 | 549 | | |
| 62' - 3" | 19 | 6' - 9" | 2 | 48' - 9" | 15 | 3-3-3-2-2-3-3 | 1262 | 573 | | |

EXPLANATION OF CANTILEVERED SECTIONS

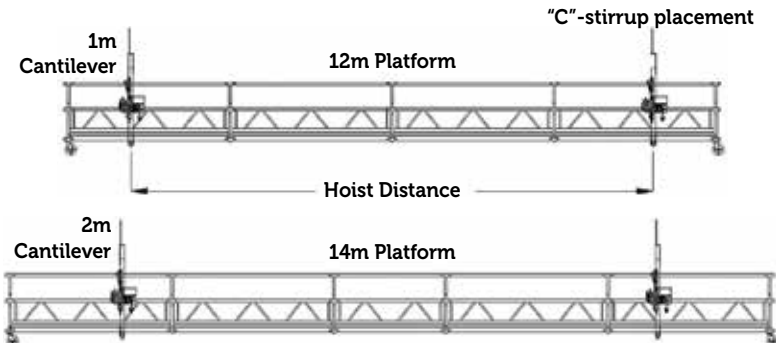

TOTAL PLATFORM WEIGHT INCLUDES:

(4) casters, (2) end or low profile C-stirrups, (2) roller bumpers, EXCLUDES hoists or electric cable.

NOTES:

- All platform configurations as shown in the chart were tested and classified by UL.
- Any platform configuration not listed on this chart must be approved by Bee Access or a competent and trained person from an authorized dealer.
- Chart above takes into consideration the use of (2) hoists.
- Rated Working Load must be evenly distributed on Platform.



2145 Indian Road, West Palm Beach, FL 33409
Phone: 561.616.9003 www.beeaccess.com

