



2145 Indian Road, West Palm Beach, FL 33409
Phone: 561.616.9003 www.beeaccess.com

SPEC-HMA58

HOLD-ME® LIFELINE TERMINATION ANCHOR

SPEC SHEET



Designed to terminate lifelines without tying knots. The practical solution for complying with currently recognized national safety standards and reducing liability exposure.

- Use with 5/8 to 3/4" lifelines.
- 5000 lb ultimate load capacity.

HOLD-ME Complies with ANSI Z-359.1

American National Standards Institute -
Safety Requirements for Personal Fall Arrest
Systems, Sub-Systems & Components

"Knots shall not be used for load bearing end terminations."

- ANSI Z359.1 section 3.2.7.2.2

"Knots can reduce the strength of lifelines up to 50% depending on what type of knot is employed."

- National Cordage Institute

Carabiner Termination



Termination with Loop



How To Rig The HOLD-ME Lifeline Anchor

Shackle & Carabiner Termination Method

STEP #1

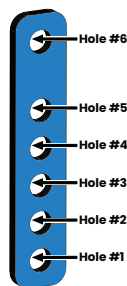

STEP #2

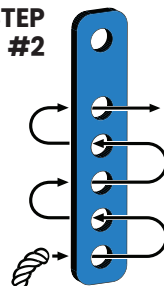

STEP #3

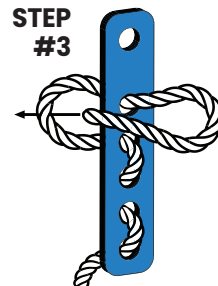

STEP #4

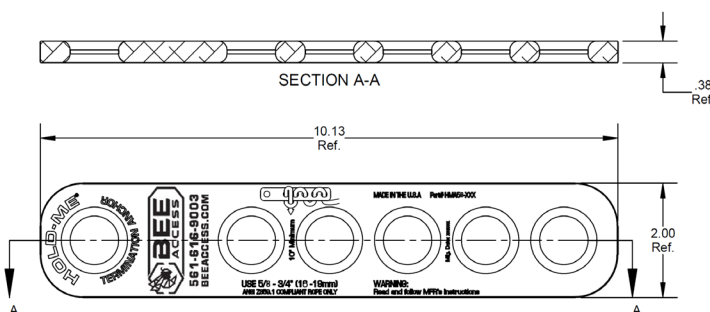
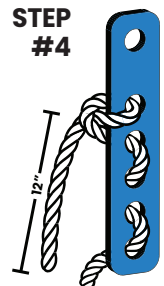

SPECIFICATIONS

Part #: HMA58

Load Capacity: 5000 lb Ultimate

Dimensions: 10.13" x 2" x 0.38" (L x W x D)

Weight: 9.3 oz

Construction: 6061-T6 Aluminum

Finish: Anodized

Custom designs with your company's logo available in various colors. Contact us for more information.